



thacoindustries.com



(+84) 933 805 707



partsales@thaco.com.vn



facebook.com/thaco.industries

THACO CHU LAI IZ, NUI THANH DIST., QUANG NAM PROVINCE, VIETNAM

**SUPPORTING INDUSTRIES & MECHANICS
CORPORATION**



CONTENTS

GENERAL INFORMATION	04
R&D CENTER	06
MATERIAL SUPPLY CENTER	10
• STEEL PROCESSING COMPANY	
MECHANICAL MANUFACTURING CENTER	16
• MOLDS COMPANY	
• MECHANICAL COMPLEX	
• HEAVY STEEL STRUCTURE COMPANY	
SUPPORTING INDUSTRIES MANUFACTURING CENTER	32
• PLASTIC COMPONENTS COMPANY	
• GLASS COMPANY	
• SEAT COMPANY	
• ELECTRIC COMPONENT COMPANY	
• AIR CONDITIONER COMPANY	
• CIVIL PLASTIC AND ARGO SUPPLIES COMPANY	
• AUTOMOTIVE SPRINGS COMPANY	
• BODY PARTS COMPANY	
• COMPOSITE COMPANY	
• SEALANT & SPECIALIZED FLUID COMPANY	
• GLOVE COMPANY	
• PACKAGING COMPANY	
CERTIFICATES	52
EXPORT MARKET & CUSTOMERS	54

GENERAL INFORMATION

Supporting Industries & Mechanics Corporation - THACO INDUSTRIES has the area of 120 ha, investment capital of USD 550 million with 6,000 employees. THACO INDUSTRIES operates throughout the model of specialized industrial parks, including R&D center, Material supply center, Mechanical manufacturing center, and Supporting industries manufacturing center.

In which, **R&D center** is responsible for testing materials, controlling quality, researching - developing products to meet the customers' unique demand by applying specialized software such as HyperWorks, Teamcenter, NX, Inventor, Moldflow....

Material supply center provides materials, including steel billets, non-ferrous metals, and services: forming, shaping, pressure processing, and cutting.

Mechanical manufacturing center provides large-scale mechanical processing & surface treatment services, synchronous equipment from design - processing & production - installation to transfer operation and maintenance.

Supporting industries manufacturing center is responsible for manufacturing and processing products and components for OEM partners, domestic and foreign manufacturers; serving various fields: automotive - motorcycles, construction, industry, agriculture and civil.

THACO INDUSTRIES became a strategic partner of automotive brands as Kia, Mazda, Peugeot, Toyota, Hyundai, Isuzu and some enterprises as PITTS, Deawon, Cellmech, GAC, Doosan Vina, Makitech, TTI, JMK,... Many products have been especially exporting to USA, Germany, Australia, Canada, Korea, Japan, European markets... and ASEAN countries.

VISION

BECOME THE LEADING CORPORATION IN VIETNAM IN INDUSTRIAL
MANUFACTURING FIELD OF MECHANICS & SUPPORTING INDUSTRIES,
INTEGRATES REGIONALLY & INTERNATIONALLY

MISSION

DELIVER THE HIGHEST VALUES TO CUSTOMERS, PARTNERS;
SIGNIFICANTLY CONTRIBUTE TO THE DEVELOPMENT STRATEGY
OF VIETNAM MECHANICS & SUPPORTING INDUSTRIES



R&D CENTER

- ⚙️ Material experiments
- ⚙️ Products testing
- ⚙️ Product research - development



400
engineers
& experts



Application
of
breakthrough
new technology



Laboratory
meets
ISO 17025
standard



MATERIAL EXPERIMENTS



Hardness tester



Universal mechanical material testing machine



Ultrasonic welding point machine



Optical emission spectrometer

PRODUCTS TESTING



Hardness testing equipment



Fatigue testing equipment



Load testing equipment

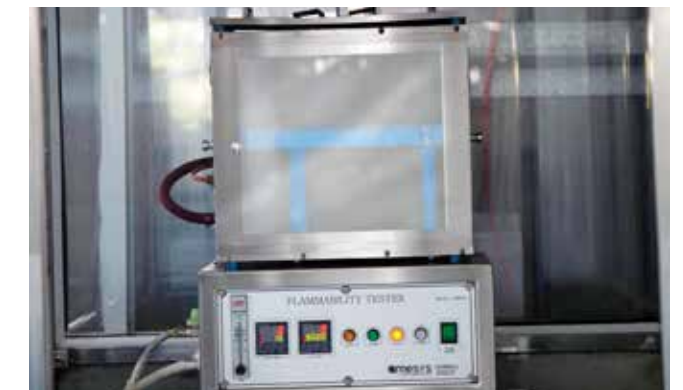

Flammability tester

PRODUCT RESEARCH - DEVELOPMENT



Application of many modern software in design, calculation, testing and simulation



Traction and compression test machine



PU padding hardness tester

MATERIAL SUPPLY CENTER

- 01 Supplying steel billets, non-ferrous metals
- 02 Services of forming, shaping, pressing and cutting





Area: 5 ha
Capacity: 255,000 tons/ year
Products: Steel material, non-ferrous metal, precision mechanical parts...



SLITTING LINE
Quantity: 03 lines
Thickness: 0.3 - 6 mm
Width: 50 - 1,200 mm



FIBER LASER CUTTING MACHINE
Quantity: 04 machines
Thickness: 25 mm
Cutting size: 12,300 x 2,000 mm



SQUARE STEEL, TUBE STEEL LASER CUTTING MACHINE
Thickness: 8 mm (steel); 4 mm (inox)
Cutting size: Ø20 – 220 mm; □15 - 155 mm



HYDRAULIC PRESS MACHINE 1,000 TONS
Press force: 1,000 tons
Working table size: 3,500 x 2,200 mm



Steel coil roll



Steel sheets,
non-ferrous metal



Square steel, tube steel



Processing profiled steel

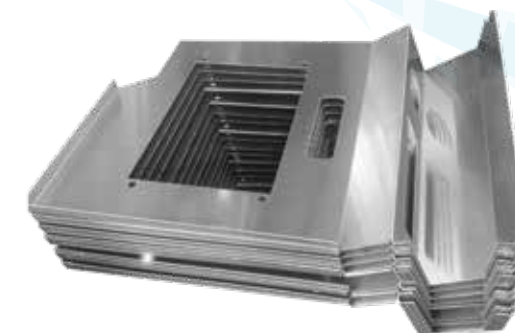

Processing billets of bus parts

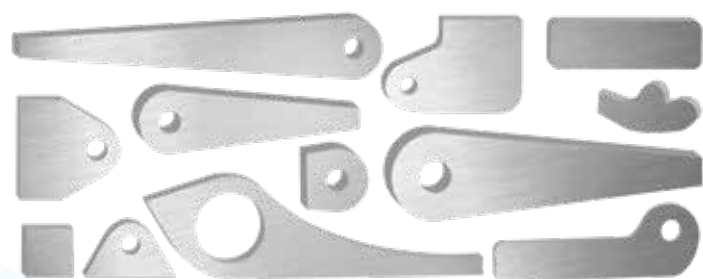

Processing billets of
dumper box and truck box



Laser cutting items

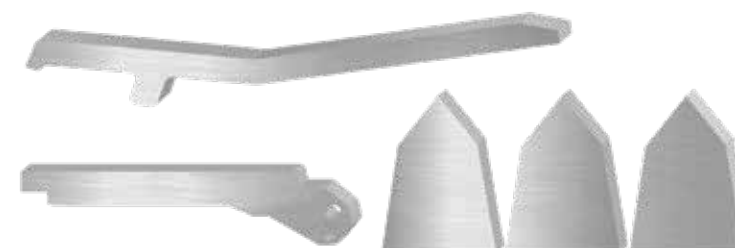

Processing billets of tractor and farm tools



Processing billets of
seat, exhaust, chassis



Processing billets of specialized vehicle box

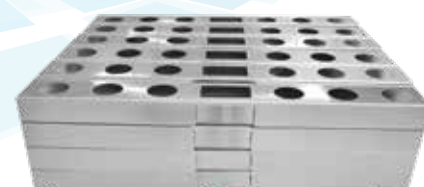

Punching & pressing parts



Stamping parts



Bending parts

MECHANICAL MANUFACTURING CENTER

- 01 Molds Company
- 02 Mechanical Complex
- 03 Heavy Steel Structure Company





Area: 5,000 m²
Capacity: 600 sets mold/year
Products: Plastic injection mold, plastic extrusion mold, stamping dies.



VERTICAL MILLING MACHINE

Quantity: 02 machines
 Max load on table: 30,000 kg
 Axis travel: 4,200 x 3,000 x 1,100 mm



CNC GUN DRILLING MACHINE

Max load on table: 20,000 kg
 Axis travel: 2,500 x 1,250 x 1,700 mm
 Drill diameter: Ø3 - 32 mm



EDM MACHINE

Max load table: 16,000 kg
 Axis travel: 2,700 x 1,100 x 600 mm



HEAT TREATMENT FURNACE

Weight: 450 kg
 Size: 1,000 x 1,150 x 800 mm
 Hardness: 58 - 62 HRC



CHUYÊN HÀN WELDING LINE

Area: 13 ha
Capacity: 300,000 mechanical component sets/ year
Products: Automobile mechanics, construction mechanics, industrial equipment, agro-forestry mechanics, surface treatment...



ED COATING LINE
Embedded large detail long 18m
Impact resistance: > 50 kg.cm
Salt mist resistance: 1000 hours



SHOT BLASTING BOOTH
Workpiece load: 10,000 kg
Size: 18,000 x 2,500 x 3,500 mm



ZINC-ELECTROPLATING LINE
Load: 150 kg
Axis travel: 1,800 x 1,400 x 400 mm



POWDER COATING LINE
Load: 140 kg
Max material size: 5,500 x 2,000 x 600 mm



Area: 20 ha
Capacity: 30,000 products/ year
Products: Semi-trailers, special semi-trailer, special heavy vehicle...



CNC GAS & PLASMA CUTTING MACHINE
 Thickness: 150 mm
 Cutting size: 3,200 x 15,000 mm



CNC PRESSING MACHINE 12 METERS
 Thickness: 0.6 - 12 mm
 Workable length: 12,000 mm



CNC PLATE ROLLING MACHINE
 Maximum length: 2,550 mm
 Diameter axes: 300 mm
 Maximum thickness: 13 mm



SEMI-TRAILER CHAIN TURNING EQUIPMENT
 Max load on table: 10 tons
 Dimension: 6,000 x 4,100 x 5,000 mm



CNC milling

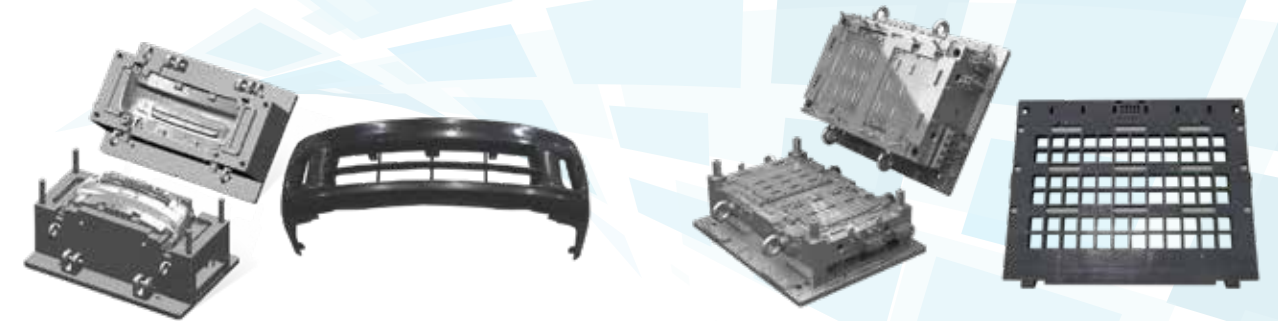

Car bumper mold

Plastic pallet mold



CNC turning

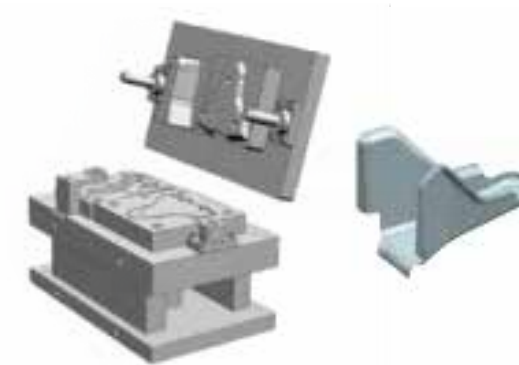

Exhaust system component stamping die



Z-section stamping die



Wire cutting, EDM

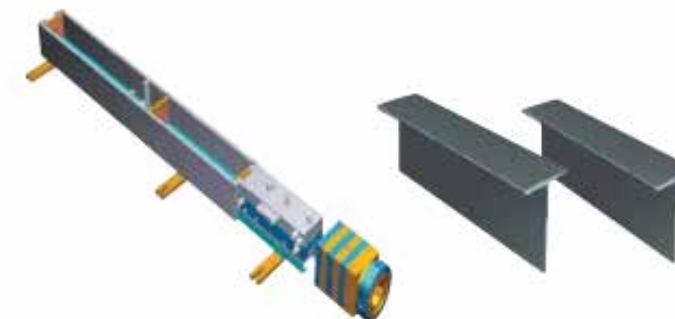

Extrusion mold for automobile

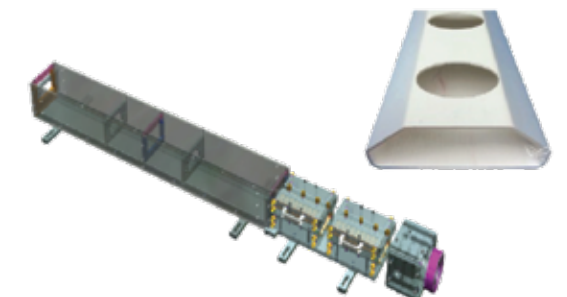

Extrusion mold for pipe of hydroponic system

PRODUCTS

INDUSTRIAL EQUIPMENT



Jig/ Fixtures



Electric monorail system



Industrial control cabinet



Tool cabinet



Automatic guided vehicle (AGV)



Crane base



Four-posts lifter

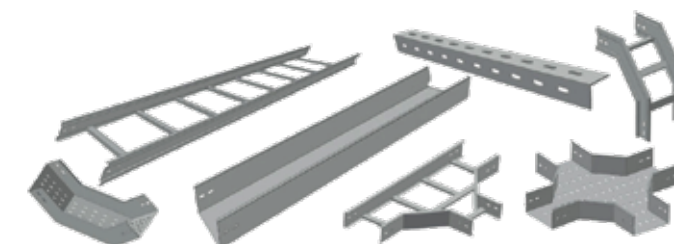

Cable trunking



Conveyor



Storage shelves



Processing line for fodder



Processing line for fruits, vegetables

PRODUCTS

AGRO-FORESTRY MECHANICS



Disc plough



Tree planting equipment

CONSTRUCTION MECHANICS



Construction and civil steel assy



Chemical sprayer system



Mixer machine



Pre-engineered steel building



Feed storage farm silo



Farm equipment



Ventilation and air-conditioning system



Construction building installation



Dump box



Refrigeration box



Seat frames



Hydraulic cylinders

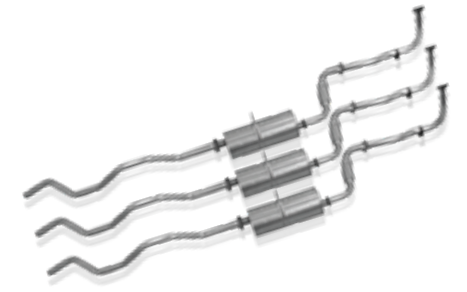

Exhaust systems



Specialized medical truck body
for X-ray and ultrasound



Specialized truck body
for mobile vaccination



45' Gooseneck
3 axles, 06 twist locks



40' Flatbed
3 axles, 08 twist locks



Fuel tank

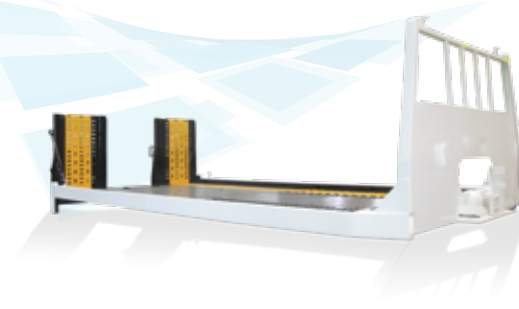

Safety loader deck



Heavy dump, 17m³



Carrier semi trailer

SUPPORTING INDUSTRIES MANUFACTURING CENTER

- 01 Plastic Components Company
- 02 Glass Company
- 03 Seat Company
- 04 Electric Component Company
- 05 Air Conditioner Company
- 06 Civil Plastic & Argo Supplies Company

- 07 Automotive Springs Company
- 08 Body Parts Company
- 09 Composite Company
- 10 Sealant & Specialized Fluid Company
- 11 Glove Company
- 12 Packaging Company





Area: 4 ha
Capacity: 32,000,000 products/year
Products: Plastic components for truck - bus - passenger car, civil & industrial plastic,...



PLASTIC EXTRUSION LINE
 Capacity: 1,000,000 meters/ year



ROBOT PAINTING
 Quantity: 5 robots
 Capacity: 160,000 sets/year

PLASTIC COMPONENTS FOR CAR



Luggage compartment



Car bumper



Seating cover



Wheel rim cover

CIVIL & INDUSTRIAL PLASTIC



Plastic bottle



Plastic core spun thread



Plastic sink



Hydroponic plastic pipe



Industrial trolleys pallet



GLASS COMPANY

Area: 6 ha

Capacity: 50,000 sets/year

Products: Truck - bus glass, passenger car windshield, truck barrel glass, electric vehicle glass, excavator glass, construction and civil glass,...



SINGLE BENDING FURNACE

Output dimension: 2,000x3,000 mm
Productivity: 380 Kw



2D GLASS TEMPERING FURNACE

Glass dimension (max): 2,200x1,500 mm
Glass thickness: 3.5~6 mm

CAR GLASS

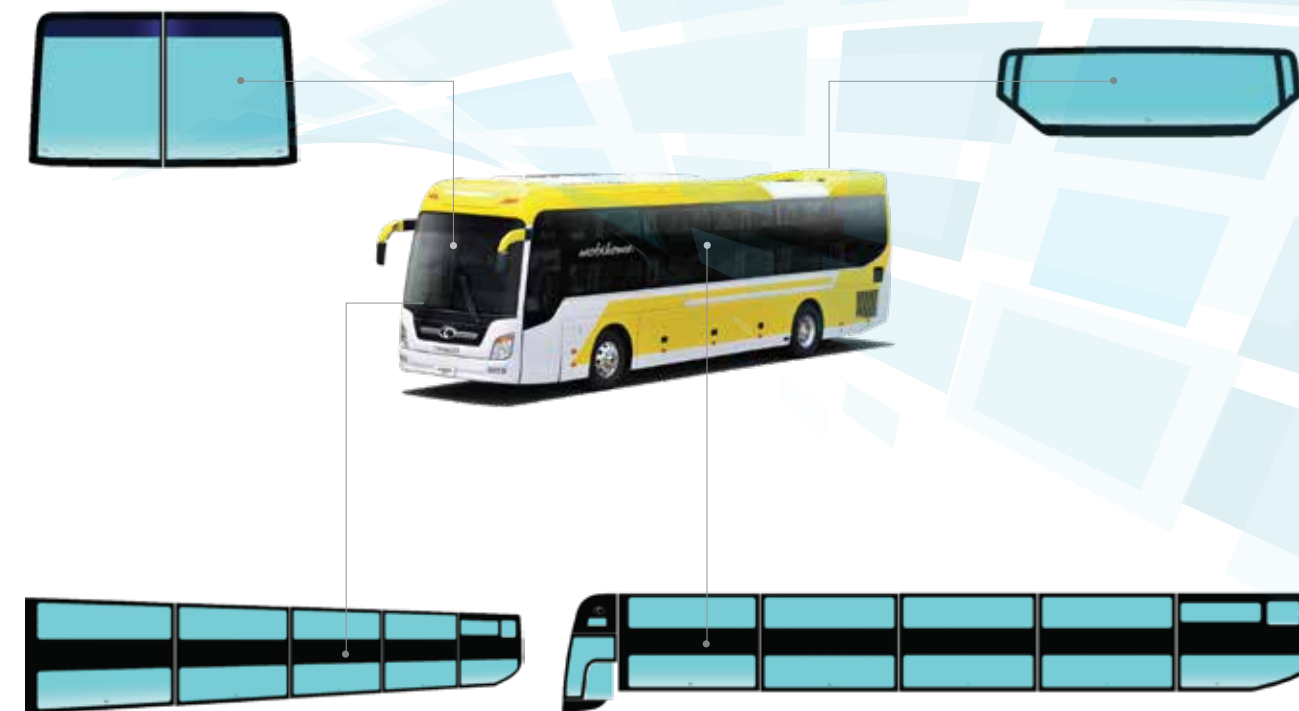

Door glass, side-fixed glass & windshield

HOUSEHOLD EQUIPMENT GLASS



Tempered glass



SEAT COMPANY

Area: 12,000 m²

Capacity: 90,000 sets of chairs - beds/year and 300,000 sets of export chairs/year

Products: Truck - bus - passenger seats, car seat components, car accessories (gear knob & seat cover, steering wheel cover, floor mat...)



AUTOMATIC SEWING MACHINE

Quantity: 800 machines
Capacity: 1,000 sets/day



CNC CUTTING LINE

Capacity: 800 sets/hour

CAR SEAT



Truck seat



Bus seat



Passenger car seat

CAR ACCESSORIES



Passenger car cover



Floor mat



Gear knob



Sun protector cover



Car cover



Backrest & neck pillow



Area: 7,000 m²

Capacity: 65,000 sets/year

Products: Truck - bus - passenger car wire harness, electric bicycle wire harness, booster cable, electronic - refrigeration wire harness,...



TERMINAL CUTTING MACHINE

Quantity: 29 machines

Capacity: 600 products/hour



AUTOMATIC CUTTING MACHINE

Quantity: 9 machines

Capacity: 1,200 products/hour

CAR WIRE HARNESS



Bus wire harness



Passenger car wire harness

ELECTRICAL - ELECTRONIC - REFRIGERATION WIRE HARNESS PRODUCTS



Electronic equipment's wire harness



Refrigeration equipment's wire harness





Area: 5,000 m²

Capacity: 300,000 sets/year

Products: Air conditioner, exhaust gas pipe, condenser for truck - bus - passenger car,...



FIN MACHINE

Strip input speed: Max 300 m/min
Fin thickness: 0.08~0.2 mm



NB FURNACE

Temperature brazing furnace: Max 650°C
Capacity: 90 products/hour



Bus evaporator



Bus air conditioner



Passenger car air conditioner



Condenser



Exhaust gas pipe



Area: 3,200 m²
Capacity: 45,000 sets/year
Products: Civil and agricultural plastic products



BLOWING PE BAGS LINE
 Screw diameter: 55 mm
 Product thickness: 0.008 - 0.2 mm
 Number of film rollers: 2



uPVC PIPE PRODUCTION LINE
 Screw diameter: 65 mm
 Pipe sizes: D60, D90, D114, D140, D168
 Control system: PLC



HDPE pipe



PP-R pipe



uPVC pipe



Sunshade net



PP plastic belt



Lanyard to prevent falling banana tree



AUTOMOTIVE SPRINGS COMPANY



Area: 2 ha
Capacity: 12,000 tons/year
Products: Light truck, medium duty truck, semi-trailer springs, leaf springs products,...



Light truck multi leaf springs



Leaf springs



Medium duty truck multi leaf springs



Semi-trailer springs



BODY PARTS COMPANY



Area: 5,000 m²
Capacity: 60,000 sets/year
Products: Body parts for car (doors, trunk lid, hood)

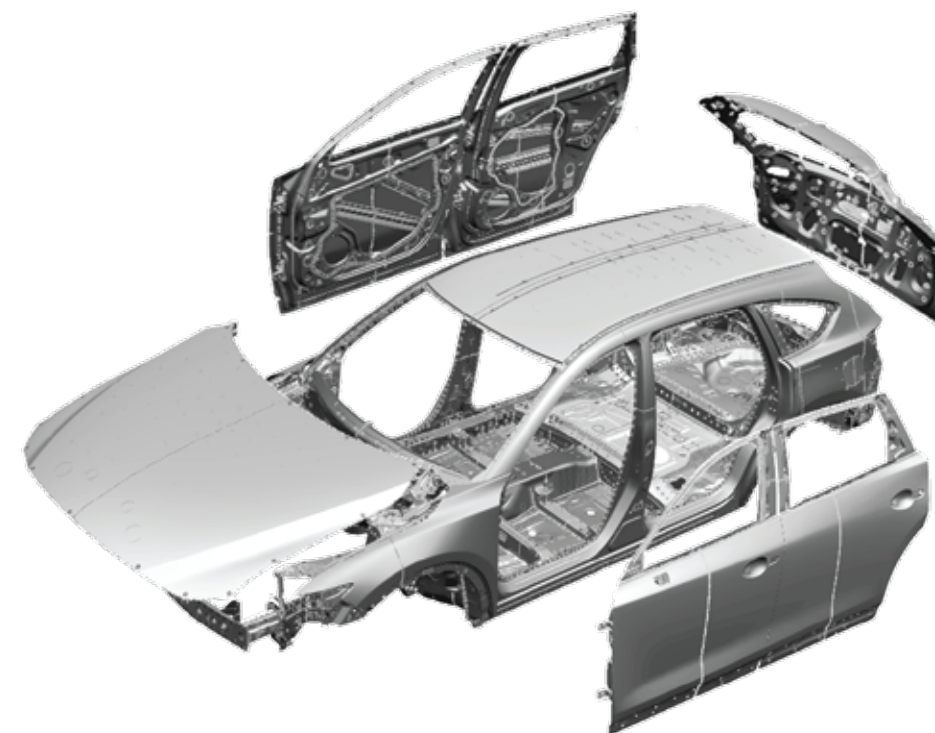



Area: 1.1 ha
Capacity: 38,000 sets/year
Products: Composite products used for construction - civil - industry - agriculture, packing, glove.



Racing seat frame



Spoiler



Medical chair



Composite flower pot



Mounted sprayer tank



Garbage can



Pre-mixed engine coolant



Silicone adhesive



Windshield washer fluid



Diesel exhaust fluid



Butyl tape



PVC body sealer

Area: 2,000 m²
Capacity: 900 tons sealant/year, 6,000 m³ specialized fluid, 1 million tape rolls/year
Products: Adhesive tape, painting workshop tape, welding workshop tape, specialized fluid.



Area: 5,600 m²
Capacity: 100 million pairs/year
Products: Latex coated glove, PVC coated glove, PU coated glove, Polyester glove, cotton glove, Nitrile coated glove.

Area: 6,000 m²
Capacity: 80,000 tons/year
Products: Carton packaging for food, electronic, furniture, fashion, agriculture.



Latex coated glove



PVC coated glove



PU coated glove



Polyester glove



Cotton glove



Nitrile coated glove

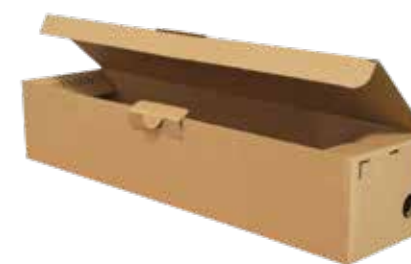

3 layers carton



5 layers carton



Waterproofing carton





- Automotive Springs Company
- Seat Company
- Interior Components Company
- Plastic Components Company
- Composite Company
- Air Conditioner Company
- Electric Components Company
- Glass Company
- Sealant & Specialized Fluid Company

- Steel Processing Company
- Molds Company
- Mechanical Complex
- Special Vehicles Company
- Body Parts Company

- Steel Processing Company
- Molds Company
- Mechanical Complex
- Special Vehicles Company
- Automotive Springs Company
- Seat Company
- Interior Components Company
- Plastic Components Company
- Air Conditioner Company
- Electric Component Company

- Glass Company
- Composite Components Company

EXPORT MARKET



Conveyor belt



Silo



Fuel tank 3,000 L



Passenger car bumper



Semi-trailer



Mechanical component

DOMESTIC CUSTOMERS



EXPORT CUSTOMERS

