



COMPANY PROFILE

www.nghiaphatsteel.com





TABLE OF CONTENTS

1. Nghia Phat Steel (NPS) Introduction
2. Mission – Vision – Core Values – Business Philosophy
3. Quality Policy – Working Safety Policy
4. Production Capacity
5. Products and Services
6. Typical Projects
7. Customers and Partners





WELCOME LETTER

First of all, **NGHIA PHAT STEEL TRADING - CONSTRUCTION - MECHANICAL JOINT STOCK COMPANY** is pleased to send greetings to health and cooperation to all customers and partners have been with us throughout time.

Ladies and gentlemen,

There is a truth that remains true till today:

“STEEL INDUSTRY IS THE REPRESENTATIVE OF HUMAN CIVILIZATION.”

Indeed, the significant milestones of the development of human civilization are the deep impression of the mining industry and the development of the steel industry in particular and metal in general. From the earliest days of an-cient Egyptian civilization over 5,000 BC, to the first industrial revolution in the second half of the 18th century and the second in the late nineteenth century in Europe, to this day: the steel industry has not only developed but more and more grown significantly, despite the efforts of humanity in the search for new alternative materials!

Therefore, it is not too excessive to say that: Mastering the technology of the steel industry is the holder of the foundation, civilization, and future of humanity. And we - **NGHIA PHAT STEEL** Company - are proud to participate in greatness and thorough process of humanity: designing and manufacturing steel structures.

With nearly 20 years of experience in the steel fabrication industry, it is not a long time; however, it is not a short one with a business, with hard work and effort on the way to development - with specialists in the design, fabrication, and erection of steel structures. **NGHIA PHAT STEEL** company, we are proud to contribute a part of our efforts to the country's growth. And one more time, to achieve our goals and mission, we are non-stop developing detailed plans to improve the company in the direction of professionalism, modernity, and efficiency to meet the increasing demand for development of the country in general and the market of the steel industry in particular.

In our business, we remain convinced: **“The business philosophy based on FAITH - MIND, as a combination of EAST-WEST, will be the motto we pursue in our efforts to develop and serve.”**

WE ARE HAPPY AS PART OF THE SUCCESS AND THE PROSPERITY OF OUR CUSTOMERS AND PARTNERS!

Sincerely thank!
General Director

TRAN THANH HA

INTRODUCTION

NGHIA PHAT STEEL is proud to be one of the companies in Vietnam in the field of high-quality mechanical engineering. Our main activities include designing, manufacturing, processing, and installing high-quality mechanical products; and other technical works in the field of construction mechanics.

With more than 20 years of experience in the mechanical engineering industry, and an annual capacity of 12,000 tons of steel structures, **NGHIA PHAT STEEL** is confident reaching your requirements with full range of steel structure works such as factories, warehouses, houses, and projects for heavy industry, trade center, exhibition center, infrastructure, etc.

NGHIA PHAT STEEL

TRADING - CONSTRUCTION - MECHANICAL JOINT STOCK COMPANY

Address: Lot C2-5, Area C2, N7 Road
Tan Phu Trung Industrial Park, Cu Chi District,
Ho Chi Minh City, Vietnam

Representative Office: 9th floor, Nam Viet Building,
261 Hoang Van Thu, Ward 2, Tan Binh District,
Ho Chi Minh City, Vietnam

Phone: (+84) 777 38 20 20 - (+84) 28 3636 7490

Fax: (+84) 28 35.920.315

Website: www.nghiaphatsteel.com

Email: info@nghiaphatsteel.com

Business registration certificate:

No. 03142204068 issued by the Department of
Planning and Investment of Ho Chi Minh City on
January 16, 2017



ORGANIZATIONAL CHART

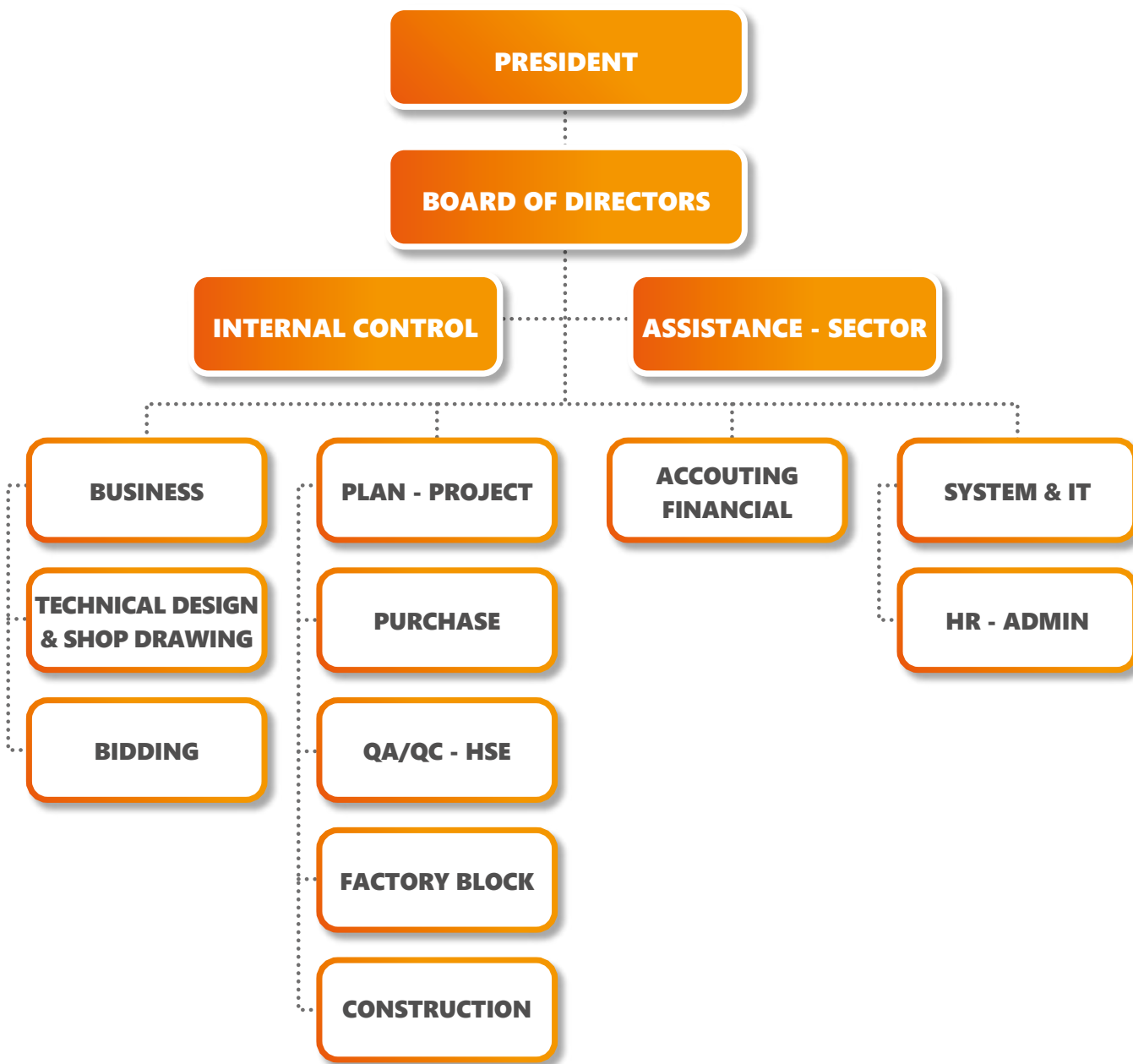

FIELD OPERATIONS

- 1 Consulting, designing, manufacturing, processing, and installing high-quality mechanical products:
 - **Steel structure and industrial steel buildings:** Workshops, warehouses, high-rise buildings, heavy industry, commercial - service centers, etc.
 - **Water tower, tank:** steel or stainless steel.
 - **Machinery - mechanical equipment:** conveyors, lifts, crane frames, etc.
 - **Environmental treatment equipment system:** Vacuuming, gas treatment, wastewater treatment, water treatment, etc.
- 2 Bidding, consulting, designing, and constructing civil, industrial, and high-rise building projects.

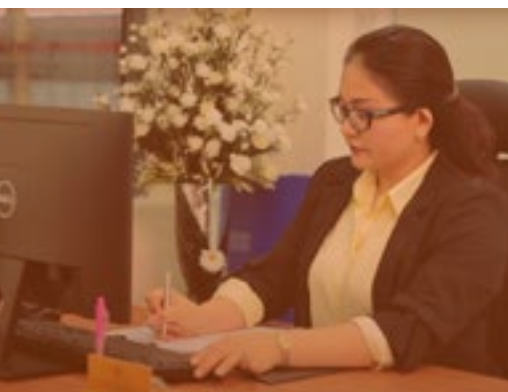

BUSINESS REGISTRATION

SỞ KẾ HOẠCH VÀ ĐẦU TƯ
THÀNH PHỐ HỒ CHÍ MINH
PHÒNG ĐĂNG KÝ KINH DOANH

CỘNG HÒA XÃ HỘI CHỦ NGHĨA VIỆT NAM
Độc lập – Tự do – Hạnh phúc

**GIẤY CHỨNG NHẬN ĐĂNG KÝ DOANH NGHIỆP
CÔNG TY CỔ PHẦN**

Mã số doanh nghiệp: 0314204068
Đăng ký lần đầu: ngày 16 tháng 01 năm 2017

1. Tên công ty
Tên công ty viết bằng tiếng Việt: CÔNG TY CỔ PHẦN CƠ KHÍ XÂY DỰNG THƯƠNG MẠI NGHĨA PHÁT STEEL
Tên công ty viết bằng tiếng nước ngoài: NGHIA PHAT STEEL TRADING CONSTRUCTION MECHANICAL JOINT STOCK COMPANY
Tên công ty viết tắt:

2. Địa chỉ trụ sở chính
Lô C2-5, Khu C2, Đường N7, Khu công nghiệp Tân Phú Trung, Xã Tân Phú Trung, Huyện Củ Chi, Thành phố Hồ Chí Minh, Việt Nam
Điện thoại: 0837192094 Fax:
Email: ketoancknghiaphat@gmail.com Website:

3. Vốn điều lệ
Vốn điều lệ: 50.000.000.000 đồng
Bằng chữ: Năm mươi tỷ đồng
Mệnh giá cổ phần: 10.000 đồng
Tổng số cổ phần: 5.000.000

4. Người đại diện theo pháp luật của công ty
* Họ và tên: TRẦN THANH HÀ Giới tính: Nam
Chức danh: Chủ tịch Hội đồng quản trị kiêm Giám đốc
Sinh ngày: 17/07/1968 Dân tộc: Kinh Quốc tịch: Việt Nam
Loại giấy tờ chứng thực cá nhân: Chứng minh nhân dân
Số giấy chứng thực cá nhân: 024099397
Ngày cấp: 21/12/2013 Nơi cấp: Công an thành phố Hồ Chí Minh
Nơi đăng ký hộ khẩu thường trú: 125 Đường Tân Thới Nhất 17, Khu phố 4, Phường Tân Thới Nhất, Quận 12, Thành phố Hồ Chí Minh, Việt Nam
Chỗ ở hiện tại: 125 Đường Tân Thới Nhất 17, Khu phố 4, Phường Tân Thới Nhất, Quận 12, Thành phố Hồ Chí Minh, Việt Nam

TRƯỞNG PHÒNG
PHÓ TRƯỞNG PHÒNG
PHÒNG ĐĂNG KÝ KINH DOANH
Vũ Thành Thơ

CERTIFICATE OF CONSTRUCTION ACTIVITY CAPABILITY

ỦY BAN NHÂN DÂN
THÀNH PHỐ HỒ CHÍ MINH
SỞ XÂY DỰNG

CỘNG HÒA XÃ HỘI CHỦ NGHĨA VIỆT NAM
Độc lập - Tự do - Hạnh phúc

**CHỨNG CHỈ
NĂNG LỰC HOẠT ĐỘNG XÂY DỰNG**

Số: HCM-00019678
(Ban hành kèm theo Quyết định số: 1896/QĐ-SXD-QLNGDXD ngày 17/12/2018)

Tên tổ chức: CÔNG TY TNHH PHÁT TRIỂN CƠ KHÍ XÂY DỰNG - THƯƠNG MẠI NGHĨA PHÁT

Giấy chứng nhận đăng ký doanh nghiệp/Quyết định thành lập số: 0312887115
Ngày cấp: Đăng ký cấp lần đầu ngày 11/08/2014;
Nơi cấp: Sở Kế hoạch và Đầu tư Thành phố Hồ Chí Minh;
Tên người đại diện theo pháp luật:
Ông/Bà: **Trần Thanh Hà** Chức vụ: Giám đốc
Địa chỉ trụ sở chính: 170 Quốc lộ 1A, phường Tân Thới Nhất, Quận 12, TP. HCM
Số điện thoại: Số fax:
Email: Website:

Phạm vi hoạt động xây dựng:
- Thi công xây dựng công trình dân dụng và công nghiệp: Hạng II.

Chứng chỉ này có giá trị đến hết ngày: 17/12/2028./

Thành phố Hồ Chí Minh, ngày 08 tháng 01 năm 2019

KI. GIÁM ĐỐC
SỞ PHÓ GIÁM ĐỐC
XÂY DỰNG

Lê Trần Kiên

BUSINESS REGISTRATION

SỞ KẾ HOẠCH VÀ ĐẦU TƯ
THÀNH PHỐ HỒ CHÍ MINH
PHÒNG ĐĂNG KÝ KINH DOANH

CỘNG HÒA XÃ HỘI CHỦ NGHĨA VIỆT NAM
Độc lập – Tự do – Hạnh phúc

GIẤY CHỨNG NHẬN ĐĂNG KÝ DOANH NGHIỆP
CÔNG TY TRÁCH NHIỆM HỮU HẠN HAI THÀNH VIÊN TRỞ LÊN

Mã số doanh nghiệp: 0312887115
Đăng ký lần đầu: ngày 11 tháng 08 năm 2014
Đăng ký thay đổi lần thứ: 1, ngày 02 tháng 12 năm 2021

1. Tên công ty
Tên công ty viết bằng tiếng Việt: CÔNG TY TNHH PHÁT TRIỂN CƠ KHÍ XÂY DỰNG - THƯƠNG MẠI NGHĨA PHÁT
Tên công ty viết bằng tiếng nước ngoài: NGHIA PHAT DEVELOPMENT MECHANICAL CONSTRUCTION - TRADING COMPANY LIMITED
Tên công ty viết tắt:

2. Địa chỉ trụ sở chính
Số 125 Đường TTN 17, Khu Phố 4, Phường Tân Thời Nhất, Quận 12, Thành phố Hồ Chí Minh, Việt Nam
Điện thoại: 0989 028140-0283 7192094 Fax:
Email: Website:

3. Vốn điều lệ 25.000.000.000 đồng
Bằng chữ: Hai mươi lăm tỷ đồng

4. Danh sách thành viên góp vốn

STT	Tên thành viên	Quốc tịch	Địa chỉ liên lạc đối với cá nhân; địa chỉ trụ sở chính đối với tổ chức	Phần vốn góp (VNĐ và giá trị tương đương theo đơn vị tiền nước ngoài, nếu có)	Tỷ lệ (%)	Số Giấy tờ pháp lý của cá nhân; Mã số doanh nghiệp đối với doanh nghiệp; Số Giấy tờ pháp lý của tổ chức	Ghi chú
1	TRẦN THANH HẠ	Việt Nam	536/43/46 Âu Cơ, Phường 10, Quận Tân Bình, Thành phố Hồ Chí Minh, Việt Nam	12.500.000.000	50,000	024099397	

BUSINESS REGISTRATION

2	ĐOÀN THỊ TRANG	Việt Nam	536/43/46 Âu Cơ, Phường 10, Quận Tân Bình, Thành phố Hồ Chí Minh, Việt Nam	12.500.000.000	50,000	024099394	
---	----------------	----------	--	----------------	--------	-----------	--

5. Người đại diện theo pháp luật của công ty
* Họ và tên: TRẦN THANH HẠ Giới tính: Nam
Chức danh: Giám đốc
Sinh ngày: 17/07/1968 Dân tộc: Kinh Quốc tịch: Việt Nam
Loại giấy tờ pháp lý của cá nhân: Chứng minh nhân dân
Số giấy tờ pháp lý của cá nhân: 024099397
Ngày cấp: 21/12/2013 Nơi cấp: Công an thành phố Hồ Chí Minh
Địa chỉ thường trú: 536/43/46 Âu Cơ, Phường 10, Quận Tân Bình, Thành phố Hồ Chí Minh, Việt Nam
Địa chỉ liên lạc: 536/43/46 Âu Cơ, Phường 10, Quận Tân Bình, Thành phố Hồ Chí Minh, Việt Nam

TRẦN THANH HẠ
PHÒNG ĐĂNG KÝ KINH DOANH
THÀNH PHỐ HỒ CHÍ MINH



MISSION

NGHIA PHAT STEEL brings optimal construction solutions - steel structures, satisfying customer satisfaction in many fields, and creating value for society.

VISION

NGHIA PHAT STEEL strives to reach the Top 10 companies in the field of steel structure in Vietnam by 2025.

CORE VALUES

PEOPLE

Developing staff capacity, and creating a dynamic, creative, and effective working environment.

TEAMWORK

Working on established processes, always promoting the connection of departments.

TRUST

Trust and listen to requests, opinions, and suggestions of employees, partners, and customers.

RESPONSIBILITY

Working with passion and enthusiasm to ensure the progress and quality of products.

IMPROVEMENT

Constantly updating to innovate thinking in management and production.

BUSINESS PHILOSOPHY

All production and business activities of **NGHIA PHAT STEEL** are carried out in the spirit of working responsibly with partners, customers, and the community to build a reputation for the **NGHIA PHAT STEEL** brand.

QHSE POLICY



COMMERCIAL CONSTRUCTION MECHANICAL JOINT STOCK
NGHIA PHAT STEEL (NPS)

SAFETY POLICY ENVIRONMENTAL HEALTH AND QUALITY (QHSE)

NGHIA PHAT STEEL specializes in providing: a) consulting and designing services for customers in industrial construction; b) production, construction, and erection of pre-engineered steel buildings, building workshops for civil, industrial, and commercial works; c) manufacture high-tech structural steel products; etc

NGHIA PHAT STEEL COMMITTED:

Changing and development

Continuous improvement

Continuous innovation

Customer Satisfaction

1. Safety, Health, Environmental Protection, and Quality is the significant business activities of **NGHIA PHAT STEEL** and are the responsibility of all **NGHIA PHAT STEEL** members.
2. Fully comply with relevant laws, regulations, conventions, and standards of Vietnam and internationally to ensure quality, environmental protection, and absolute safety in service, production and/or other business activities.
3. Regularly upgrade and renew all technical equipment and technology; improve professional qualifications, professional style, and continuous improvement to satisfy the requirements of customers and authorities where **NGHIA PHAT STEEL** conducts production and business activities.
4. Identify, prevent and minimize risks; ensure avoiding environmental pollution and disease injuries to help avoid loss of life, property, and environment in all activities by **NGHIA PHAT STEEL**. Create and maintain a safe, quality-assured production, business, and service environment.
5. To apply synchronously and fully the Management Systems of Safety, Health, Environment, Quality, and advanced systems specific to the industry. Regularly review and continuously improve management systems to improve production, business, and management efficiency in all activities of **NGHIA PHAT STEEL**.
6. All officers and employees of **NGHIA PHAT STEEL** are responsible for implementing this Policy!

ISO 9001 CERTIFICATE

Bureau Veritas Certification



**NGHIA PHAT STEEL TRADING CONSTRUCTION MECHANICAL
JOINT STOCK COMPANY**

LOT C2-5, AREA C2, ROAD N7, TAN PHU TRUNG INDUSTRIAL PARK, CU
CHI DISTRICT, HO CHI MINH CITY, VIETNAM

*Bureau Veritas Certification Holding SAS – UK Branch certifies that the Management System of
the above organisation has been audited and found to be in accordance with the requirements
of the management system standards detailed below*

ISO 9001:2015
Scope of certification

FABRICATION MECHANICAL: METAL, STEEL.
MANUFACTURING STEEL STRUCTURES: FACTORY, WAREHOUSE, MECHANICAL
EQUIPMENT.
MANAGING CONSTRUCTION OF CIVIL ENGINEERING WORKS.

Original Cycle Start Date:

19-09-2022

Expiry date of previous cycle:

NA

Certification / Recertification Audit date:

NA

Certification / Recertification cycle start date:

19-09-2022

Subject to the continued satisfactory operation of the organization's
Management System, this certificate expires on:

18-09-2025

Certificate No.:

VN009630

Rev.:

1

Issue date:

19-09-2022



LUU THI MAI HUONG



Certification Body Address: 5th Floor, 66 Prescott Street, London, E1 8HG, United Kingdom
Local Office: Unit 4.4A, 4th Floor, E-Town 1 Building, 364 Cong Hoa Street, Tan Binh District, Ho Chi Minh City, Vietnam

Further clarifications regarding the scope and validity of this certificate, and the applicability of the management system requirements, please call: +84 28 3812 2248.



1/1

PRODUCTS & SERVICES

Nghia Phat Steel provides a package solution that includes consulting, designing, manufacturing, erection, and warranty service for steel structure products with international standards:

- ISO 9001: 2015
- ISO 14001: 2015
- ISO 3834-2: 2021

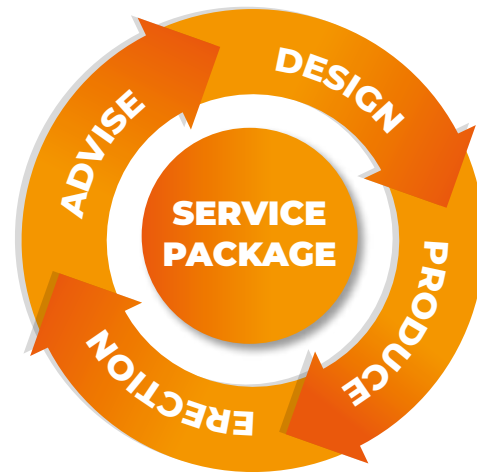

**HIGH-RISE
STEEL BUILDING**



**MACHINERY
MECHANICAL EQUIPMENT**



CIVIL WORKS



**ENVIRONMENTAL
TREATMENT SYSTEM**



BW 27 - BW Industrial Shopee
Tan Phu Trung IP, Cu Chi Dist., HCMC



OVERVIEW OF INDUSTRIAL STEEL BUILDING

INDUSTRIAL STEEL BUILDINGS

INDUSTRIAL STEEL BUILDINGS are houses made from steel structures and fabricated and installed according to pre-specified architectural and technical drawings. The process of manufacturing finished products (with a combination of inspection and quality control steps) goes through 3 main stages: design, fabrication of components and erection at the site. The entire steel structure can be produced synchronously and then delivered to the construction site in a relatively short time.

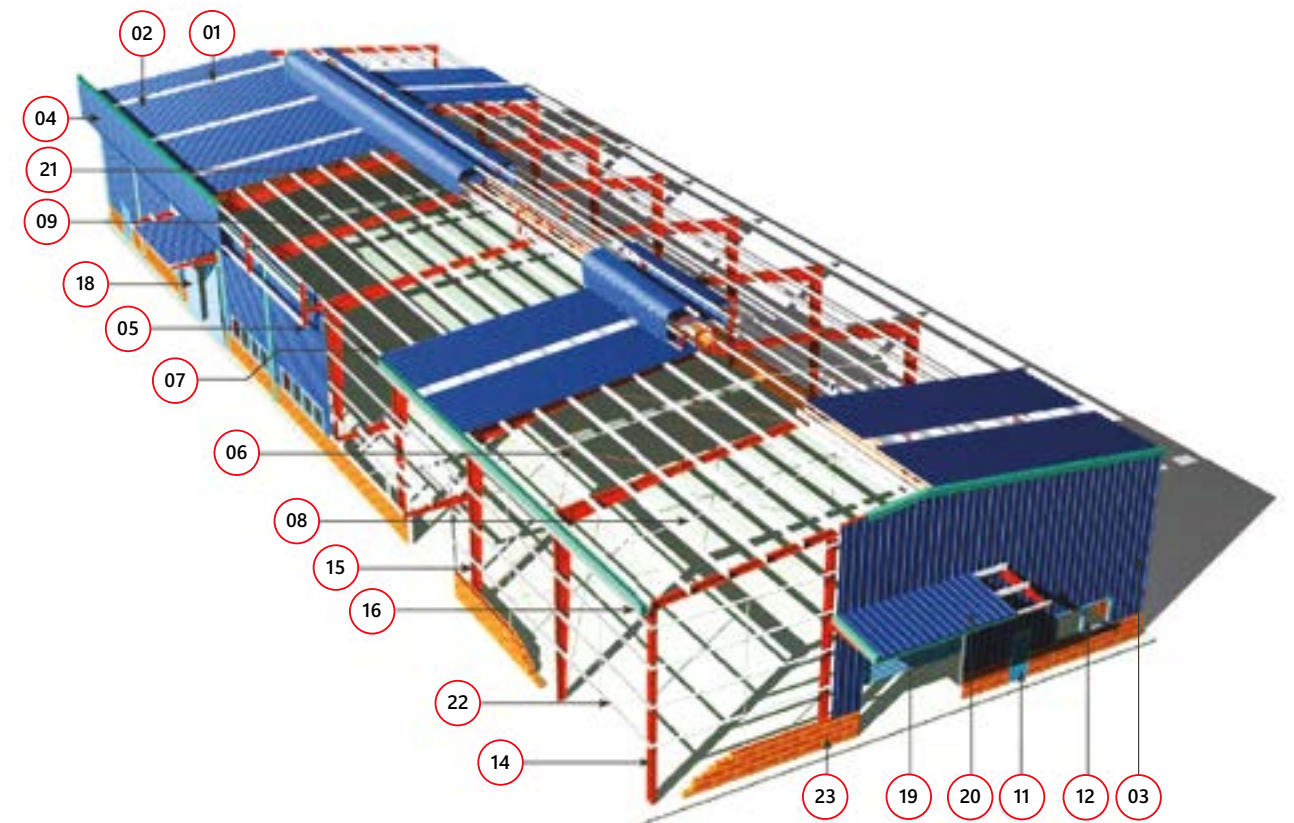

- | | | |
|----------------------|-------------------------|-------------------------|
| 01 Translucent sheet | 09 Purlin | 17 Down pipe |
| 02 Roofing | 10 Fly bracing | 18 Double sliding doors |
| 03 Walling | 11 Personal door | 19 Rolled door |
| 04 Curved fascia | 12 Aluminium glass door | 20 Canopy |
| 05 Fascia frame | 13 Louver | 21 Insulation |
| 06 Roof bracing | 14 Gable frame | 22 Girt |
| 07 Eave purlin | 15 Main frame | 23 Brick wall |
| 08 Purlin bracing | 16 Gutter | |

TYPICAL STEEL STRUCTURE MANUFACTURING PROCESS

- STEP 1 STEEL CUTTING
- STEP 2 GUSSET PLATE PROCESSING
- STEP 3 ROUGH ASSEMBLY
- STEP 4 ROUGH WELDING
- STEP 5 BEAM ADJUSTMENT
- STEP 6 FINISHING ASSEMBLY
- STEP 7 FINISHING WELDING
- STEP 8 CLEANING AND BLASTING
- STEP 9 PAINTED/GALVANIZED
- STEP 10 PACKING, SHIPPING

STANDARD STRUCTURAL SYSTEMS

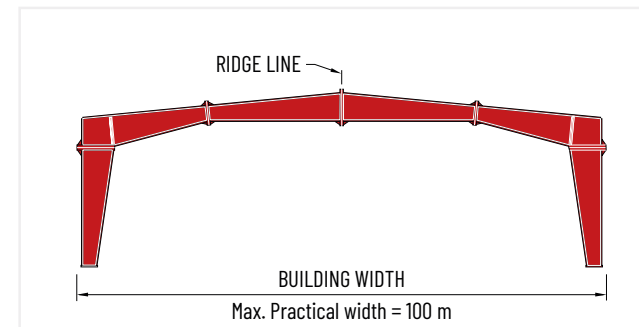

Clear Span (CS)

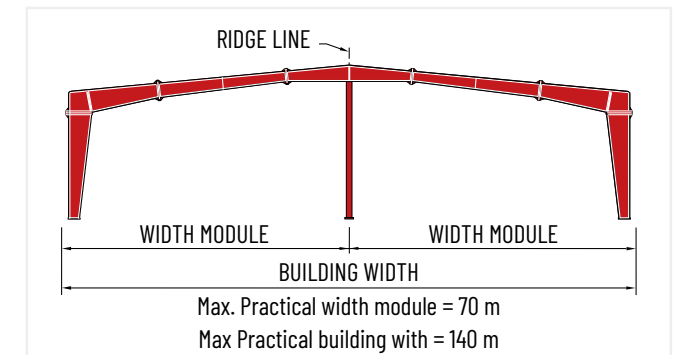

Multi-span "1" (MS-1)

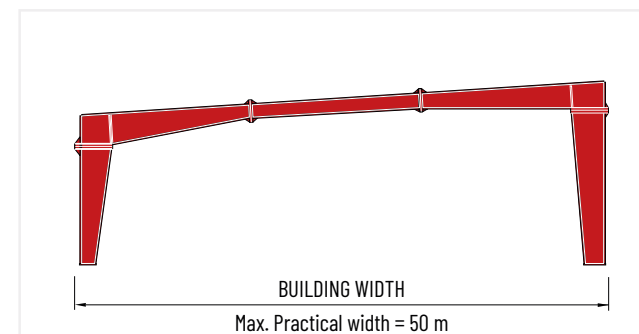

Single Slope (SS)

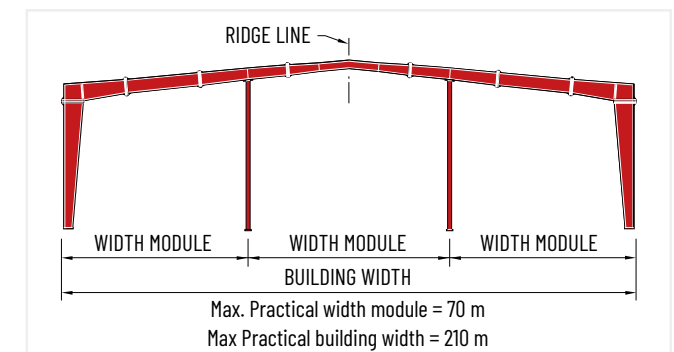

Multi-Span"2" (MS-2)

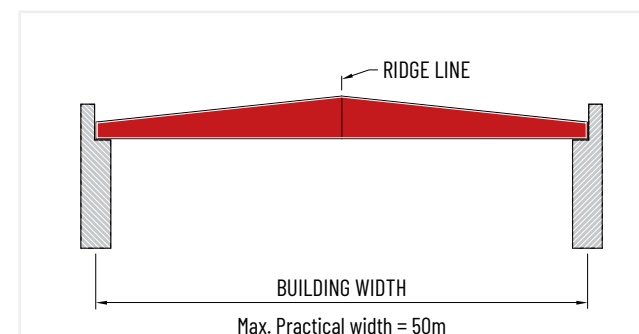

Roof System (RS)

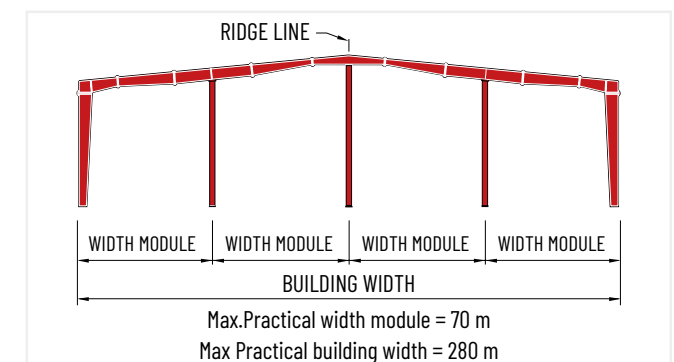

Multi-Span "3" (MS-3)

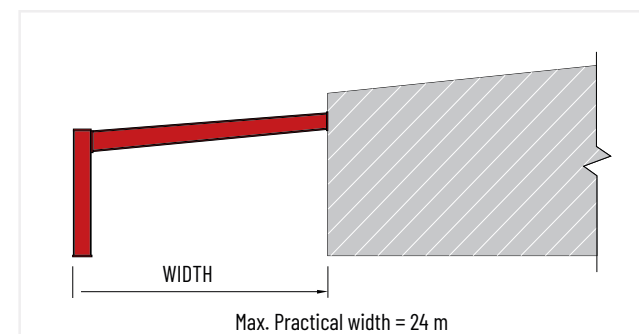

Lean-To (LT)

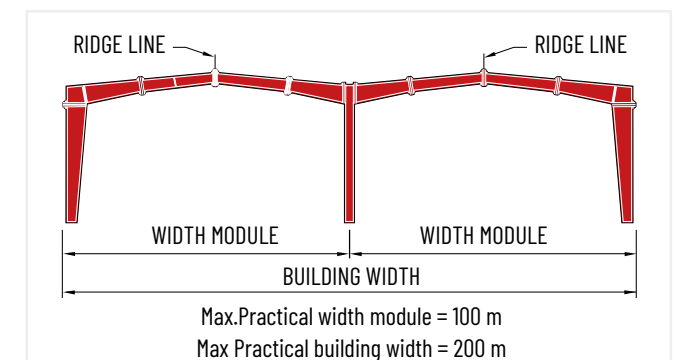

Clear Span (CS)

STANDARD STRUCTURAL SYSTEMS

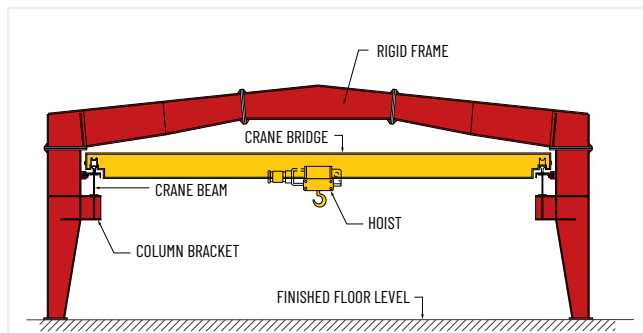

Top Running Crane

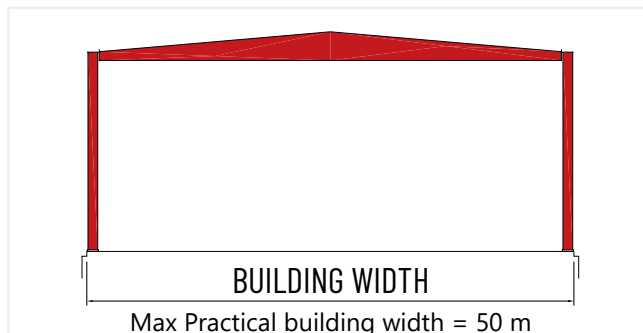

Spacesaver Building

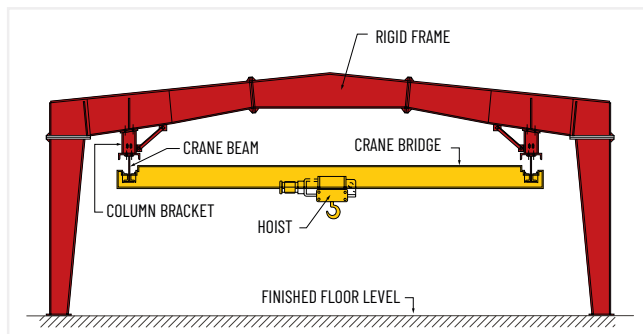

Underhung Crane

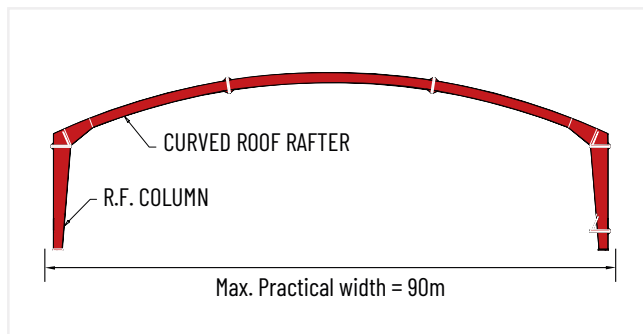

Arched Clear-Span (AS)

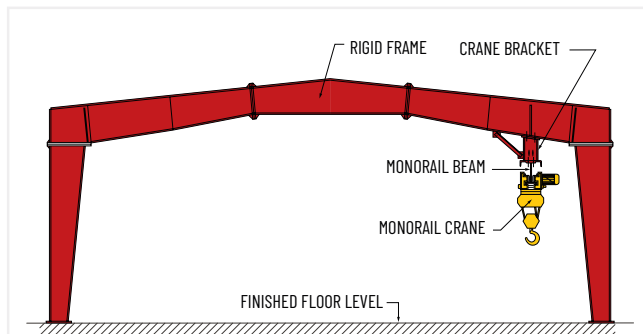

Monorail Crane

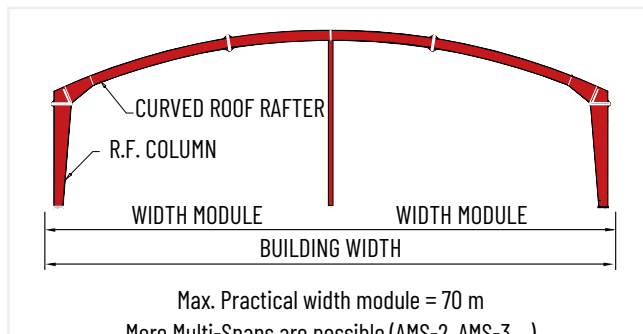

Arched Multi-Span (AMS-1)

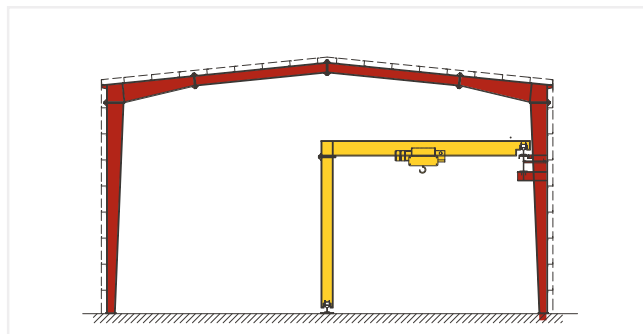

Semi Portal Crane

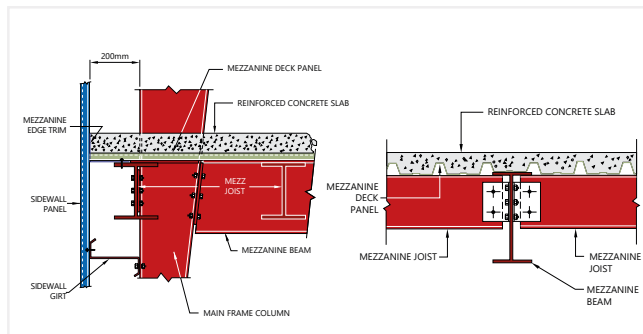

Mezzanine detail

MATERIALS & ACCESSORIES

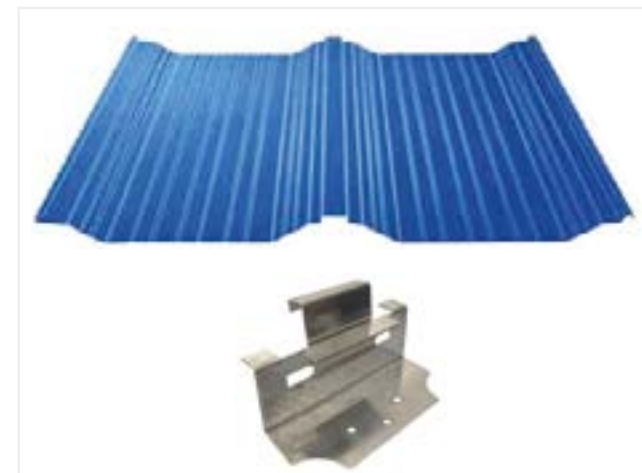

Tole Lockseam - Seam clip



Tole Klip-Lock - Lock clip



Tole 05 waves



Tole 09 waves

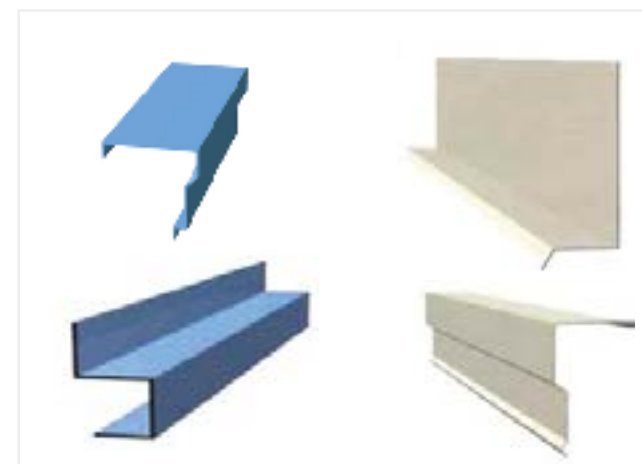

Gable trim - Eave trim - Oasis gable trim

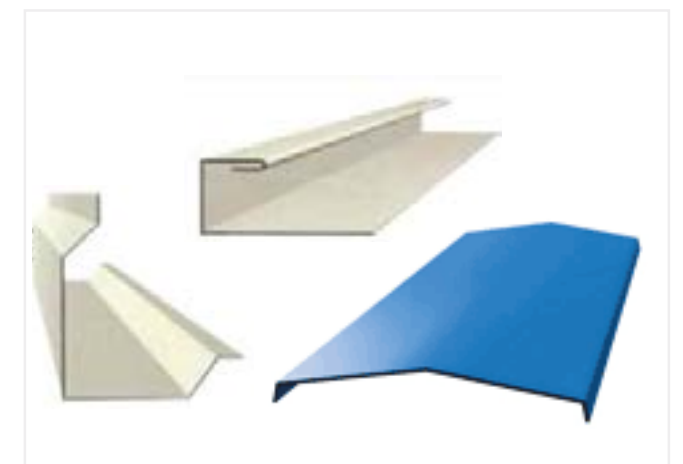

Corner trim - Framed door trim - Ridge Cap

MATERIALS & ACCESSORIES

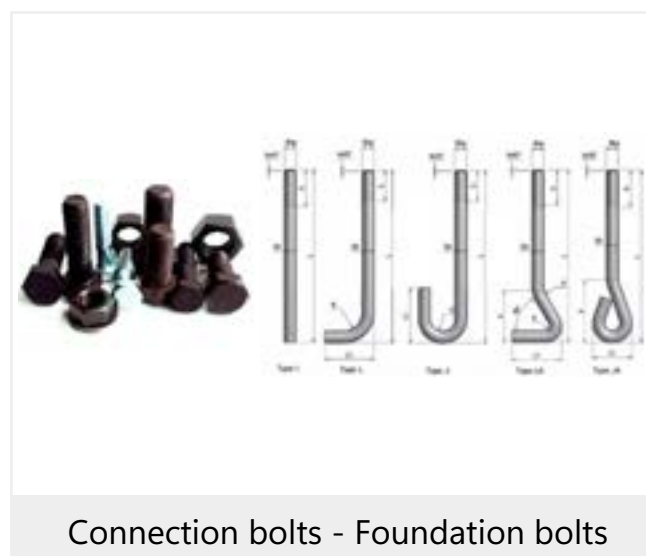

ROOFING SHEET & ACCESSORIES

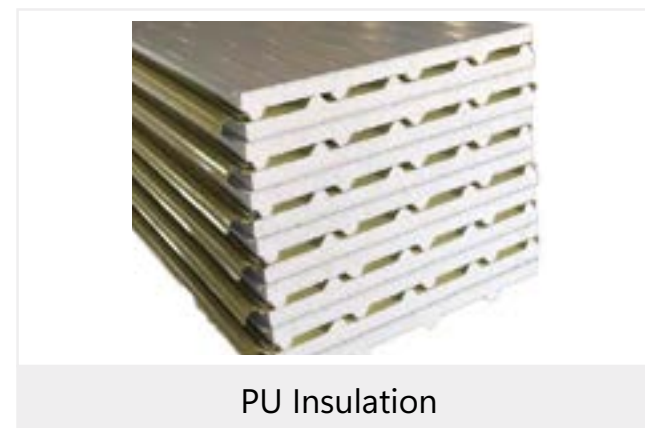
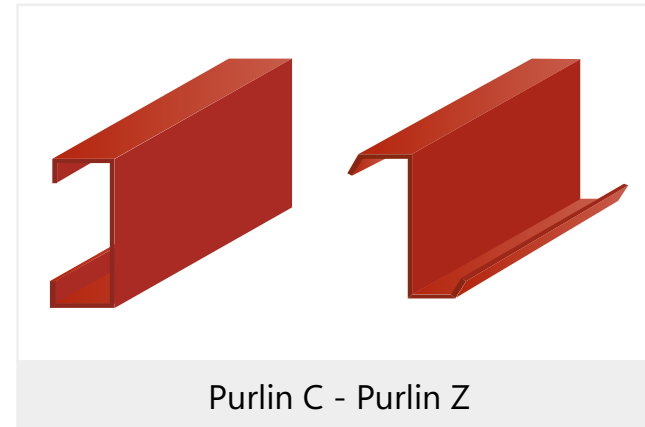

BW6 - BW Industrial
Nhon Trach 3 IP, Dong Nai Province



PRODUCTION CAPACITY

www.nghiaphatsteel.com

CAPACITY & TECHNOLOGY

- Factory area : 12,800 m²
- Processing capacity : 12,000 tons of steel structure/year

With more than 20 years in the field of steel structure, Nghia Phat Steel has had the experience and a team of highly qualified engineers to bring the most optimal solutions to customers.

NPS factory is built strictly with 5S standard with modern and highly automated equipment, strongly supporting the production of the most difficult steel structure products.

Every year, with a manufacturing area of steel structure of more than 8000m² and a system of safety cranes, advanced cutting, welding, cleaning and painting machines, we supply to the market quality components, weighing up to 20 tons, and with highly durable paint finishes.

Accompanying is the quality management system ISO 9001:2015, which requires all components to be inspected, checked strictly, meticulously to every detail by advanced technological equipment for quality assurance prior to shipment and installation at site.



DESIGN SOFTWARE

NGHIA PHAT STEEL's engineering team constantly updated with modern software and the latest international design trends with the goal of creating optimal solutions for the project.



THE LATEST INTERNATIONAL STANDARD

AWS 2015

Welding code

ASCE 7-16

Building code

IBC 2015

International building code

MBMA 2012

Metal Building Systems Manual

AISC 360-16

Specification for Structural Steel Buildings

AISI S100-16

North American Specification for the Design of Cold-Formed

EQUIPMENT & PRODUCTION LINE



Steel plate cutting machine
22mm - 6m



Steel plate cutting machine
16mm-4m



CNC cutting machine



CNC punching machine



Beam assembly machine



Vertical welding machine



Horizontal welding machine



Beam bending machine



Sand blasting machine



Double roll forming machine



Nghia Phat Steel Factory



DELICACY Factory
Bau Bang IP, Binh Duong Province



TYPICAL PROJECT

www.nghiaphatsteel.com

FACTORY - WAREHOUSE



BW7 - BW Industrial

- S= 16.000 m²
- VSIP 2A IP, Binh Duong Province
- Category: Warehouse and Roofing



FACTORY - WAREHOUSE



BW 27 - BW Industrial Shoppee

- S= 30.000 m²
- Tan Phu Trung IP, Cu Chi Dist., HCMC
- Category: Warehouse and Garage



FACTORY - WAREHOUSE



BW Dau Giay - BW Industrial

- S= 36.000 m²
- Dau Giay, Dong Nai Province
- Category: Warehouse B/C/D



FACTORY - WAREHOUSE



BW8 - BW Industrial

- S= 22.000 m²
- My Phuoc 4 IP, Binh Duong Province
- Category: Warehouse, Garage and Support system.



FACTORY - WAREHOUSE



Sethia Hemraj Rice Oil Factory

- Sa Dec IP, Dong Thap Province
- Category: Manufacturing and Installing steel structure
 - Tower 1: Cooling Tower
 - Tower 2: Prep. Tower
 - Tower 3: Extraction Building
- Stage 2
 - Tower 3 Extraction
 - Tower 4: Refinery Building
 - Storage warehouse



FACTORY - WAREHOUSE



BW6 - BW Industrial

- S= 21.000 m²
- Nhon Trach 3 IP, Dong Nai Province
- Category: Warehouse FB1, FB3



FACTORY - WAREHOUSE



Apache Vietnam Shoe Factory

- S= 20.000 m²
- Long Giang IP, Tien Giang Province
- Category: Warehouse #3, Automatic Warehouse, Office Building, Public Building, Garage-Cafeteria, Chemical Storage.



FACTORY - WAREHOUSE



Da Fang Wood Furniture Factory

- S= 12.000 m²
- Ho Nai IP, Dong Nai Province
- Category: Warehouse #2, Painting factory



FACTORY - WAREHOUSE



Jiangsu Goutai Factory - Hantex Group

- Phuoc Dong IP, Tay Ninh Province
- Category: Warehouse, Boiler house, and roofing



FACTORY - WAREHOUSE



CP Vietnam Factory

- Binh Phuoc Province



FACTORY - WAREHOUSE



Minh Man Label Printing Factory

Tan Phu Trung IP, Cu Chi District,
Ho Chi Minh City



FACTORY - WAREHOUSE



Nhat Binh Minh Stainless Steel Joint Stock Company

Construction, Erection

MAJOR CRAFT – JAPAN Factory

Amata IP, Dong Nai Province



Cerubo Factory

Construction

Lien Anh Company

Design & Construction of a
leather shoe material center,
Binh Duong Province



FACTORY - WAREHOUSE



CARGIL factory

Hung Yen Province

Pomina Steel Factory

Ba Ria - Vung Tau Province



New Wide Factory

Construction

Warehouse



FACTORY - WAREHOUSE



Lam Dong BOXIT Factory

Warehouses & Conveyors



DELICACY Factory

Bau Bang IP, Binh Duong Province

BAMBOO Factory

My Phuoc 3 IP, Binh Duong Province



NEW WIDE Cold Storage

Phuoc Dong, Tay Ninh Province



FACTORY - WAREHOUSE



**CHIN WELL Fasteners
Viet Nam Factory**

Dong Nai Province



PRO WELL Factory

Long Khanh City, Dong Nai Province



**Can Spost Leather
Shoes Factory**

Tay Ninh Province

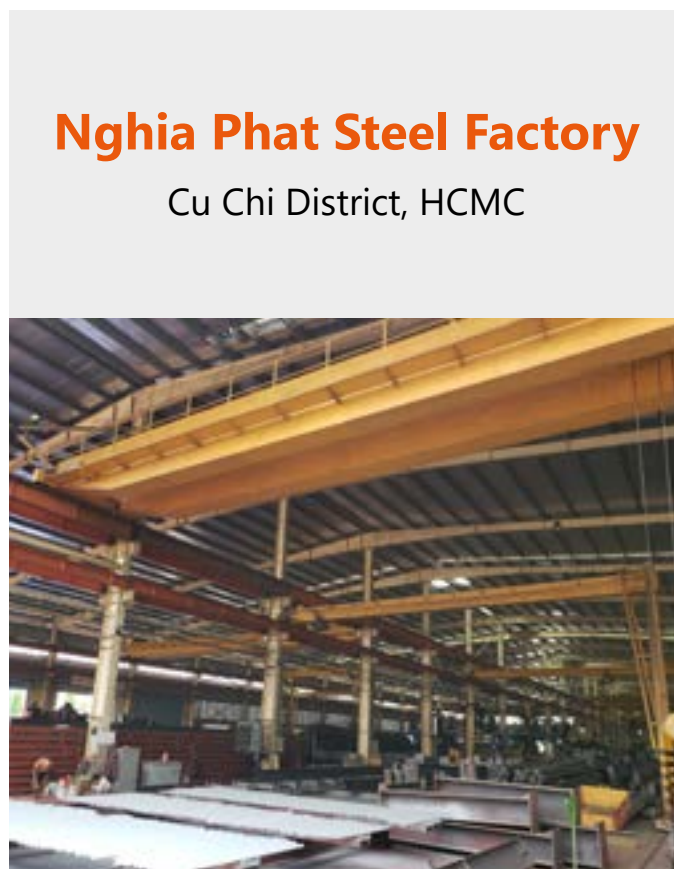

Nghia Phat Steel Factory

Cu Chi District, HCMC

MACHINERY MECHANICAL EQUIPMENT



Conveyor chain



Cargo lift table

P=80T



**PTSC-2 Port
Conveyor**



PTSC Port Conveyor

MACHINERY MECHANICAL EQUIPMENT

Anlong factory cooking oil tank

$V=3.000m^3$



Tank of Duyen Hai 3 Thermal Power Plant

$V=3.000m^3$ - Tra Vinh Province

Goods lifts

$P=3T, H=40m$ Feed Mill



Steel fountain

CIVIL WORKS



FORD Pho Quang Showroom

HCMC

VOLVO Phu My Hung Showroom

HCMC



Nguyen Kim Supermarket

63 - 65 Tran Hung Dao st.,
District 1, HCMC

GALAXY CINEMA

119 Nguyen Van Qua st.,
HCMC



CIVIL WORKS



KONE Academy

390 Hoang Van Thu st, HCMC



The First Phan Khang Supermarket

431 Hoang Van Thu st.,
Tan Binh District, HCMC

NPS Office Building

Cu Chi District, HCMC



ENVIRONMENTAL TREATMENT SYSTEM



Industrial solid waste incineration system



Industrial wastewater treatment system



Generator smoke treatment system



Industrial paint waste incineration & treatment line

ENVIRONMENTAL TREATMENT SYSTEM



Factory dust extraction system



Hazardous waste incineration station



Bucket system and material storage cylinder



Exhaust treatment system





CUSTOMERS & PARTNERS





www.nghiaphatsteel.com

NGHIA PHAT STEEL TRADING - CONSTRUCTION - MECHANICAL JOINT STOCK COMPANY

 Office: 9th floor, Nam Viet Building, 261 Hoang Van Thu, Ward 2, Tan Binh District, HCMC, Vietnam
 Lot C2-5, Area C2, N7 Road, Tan Phu Trung Industrial Park, Cu Chi District, HCMC, Vietnam
 (+84) 777 86 20 20 - (+84) 28 3636 7490  info@nghiaphatsteel.com  MST: 0314204068